



MT Series

HOUSINGS
MULTIPLE CARTRIDGES
MEDIUM-LOW FLOW-RATE

MAIN APPLICATIONS:

- DESALINATION
- WATER TREATMENT
- FINE CHEMICAL
- PETROCHEMICAL
- FOOD & BEVERAGE
- POWER GENERATION
- PAINTS AND RESIN
- PHARMACEUTICAL
- MICROELECTRONIC
- GALVANIC
- HYDRAULIC
- STEEL MILL
- GENERAL INDUSTRY

CHARACTERISTICS:

- 100% 316-SS construction.
- Swing bolts Rathmann type closure.
- Micro-casting girth flange and top cover with hinge and handle.
- Conform to 2014/68/UE PED Directive.
- Conform to 2014/34/UE ATEX Directive.
- 1935/2004/CE certification available upon request.
- Suitable for liquid and gas Gr. 1 and 2 filtration.
- Side inlet bottom outlet nozzles design.
- Suitable for pressure up to 10 bar (*higher pressure as option*).
- Suitable for DOE or cod.3 filtering cartridges (*cod.8 as option*).
- Suitable for 3 to 12 filtering cartridges up to 40" (*standard*).
- Tailor made design available (*as option*).
- O-ring body/head seal.
- 430-SS adjustable legs.
- Hydraulic test on 100% of manufactured filters.
- Customization for OEM available.

ASCO FILTRI

a **mott** company



MT Series

HOUSINGS
MULTIPLE CARTRIDGES
MEDIUM-LOW FLOW-RATE

TECHNICAL DATA

MAX. WORKING CONDITIONS
 10 bar @ 100 °C
 16 bar @ 100 °C (as option)

CONSTRUCTION MATERIALS

- BODY:**
 - 316L SS
MICRO CASTING HEAD (F):
 - 316 SS
MACHINED HEAD (M):
 - 316L SS
ADJUSTABLE LEGS:
 - 430 SS

FINISHING

- A38:
 Internal electropolishing
 External manual polishing
 - A44:
 Glass bead blasted
 - A13 (only MTM12):
 Int/ext electropolishing

GASKETS

- EPDM max. 120 °C
 - Viton max. 230 °C
 - Silicone max. 230 °C
 - FEP max. 250 °C
 - PTFE max. 250 °C

IN/OUT

- 1.1/2" GAS-M
 - 2" GAS-M
 - 2.1/2" GAS-M
 - 3" GAS-M
 - DN 100 PN 16
 - DN 150 PN 16

VENT

- 3/8" GAS-F

TUBE SHEET DRAIN

- 1/2" GAS-F

ACCESSORIES

- Pressure gauge
 - Vent valve
 - Flanged connection

Dimensions:

Model	Dimensions [mm]					In/out [GAS-M]	Flow-rate [m³/h]		Vol. [lit]	Fig.
	A	B	C	D	E		Depth	Pleated		
MTM031	168.3	154	Max. 205	200	255	1.1/2"	4	6	9	1
MTM032					505		8	12	14	
MTM033					755		12	16	19	
MTM034					1005		16	18	24	
MTF051	219.1	170	Max. 340	231	322.5	2"	7.5	10	14	1
MTF052					587.5		15	20	23	
MTF053					852.5		22	30	31	
MTF054					1117.5		30	30	39	
MTF092	273	235	Max. 495	320	547.5	3"	24	36	45	2
MTF093					797.5	36	40	59		
MTF094					1047.5	45	50	73		
MTM122	323.8	262	400	450	450	4"	36	48	59	1
MTM123					700	54	72	78		
MTM124					950	72	96	97		

Water flow-rate (m³/h) based on 50 µm cartridges - Clean Delta-P 0.15 bar.
 Shown flow-rates change depending on installed filtration rating.

Max. working pressure:

Fluid	Model						
	MTM031	MTM032	MTM033	MTM034	MTM122	MTM123	MTM124
Liquid Gr. 2	10	10	10	10	10	10	10
Liquid Gr. 1	10	10	10	10	10	10	10
Gas Gr. 2	10	10	10	8.0	3.0	2.5	2.0
Gas Gr. 1	5.5	3.5	2.5	2.0	0.8	0.6	0.6

Fluid	Model						
	MTF051	MTF052	MTF053	MTF054	MTF092	MTF093	MTF094
Liquid Gr. 2	10	10	10	10	10	10	10
Liquid Gr. 1	10	10	10	10	10	10	10
Gas Gr. 2	10	8.5	6.0	5.0	4.0	3.0	2.5
Gas Gr. 1	3.5	2.0	1.5	1.0	1.0	0.8	0.6

Where the 2014/68/EU PED Directive is applicable, in case of gas, the max. working pressure must be reduced. For different pressure contact ASCO Filtri.

Contact us for any further information.

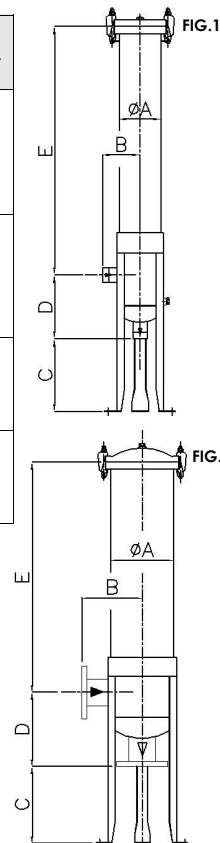

We reserve the right to change the data of this specification without notice.

ASCO Filtri S.p.A.

Viale delle Scienze, 8
 20082 Binasco (MI) - Italy
 Phone: +39 02 89703.1
 Fax: +39 02 89703.410
 E-mail: info@ascofiltri.com
 Web: www.ascofiltri.com

ASCO
FILTRI
 a mott company